

FIRE FLOW DATA	
FH #1 FLOW	= 1087 GPM
FH #2 FLOW	= 1210 GPM
FH #3 FLOW	= 1233 GPM

NOTES

WATER AND ELECTRICAL CONNECTIONS ARE THROUGH EXISTING BUILDINGS UNLESS SHOWN ON THIS PLAN. SEE M.E.P. DRAWINGS FOR UTILITY CONNECTIONS.

CONTRACTOR SHALL FIELD VERIFY LOCATIONS OF ALL EXISTING UTILITIES BEFORE FURTHER DEMOLITION/CONSTRUCTION.

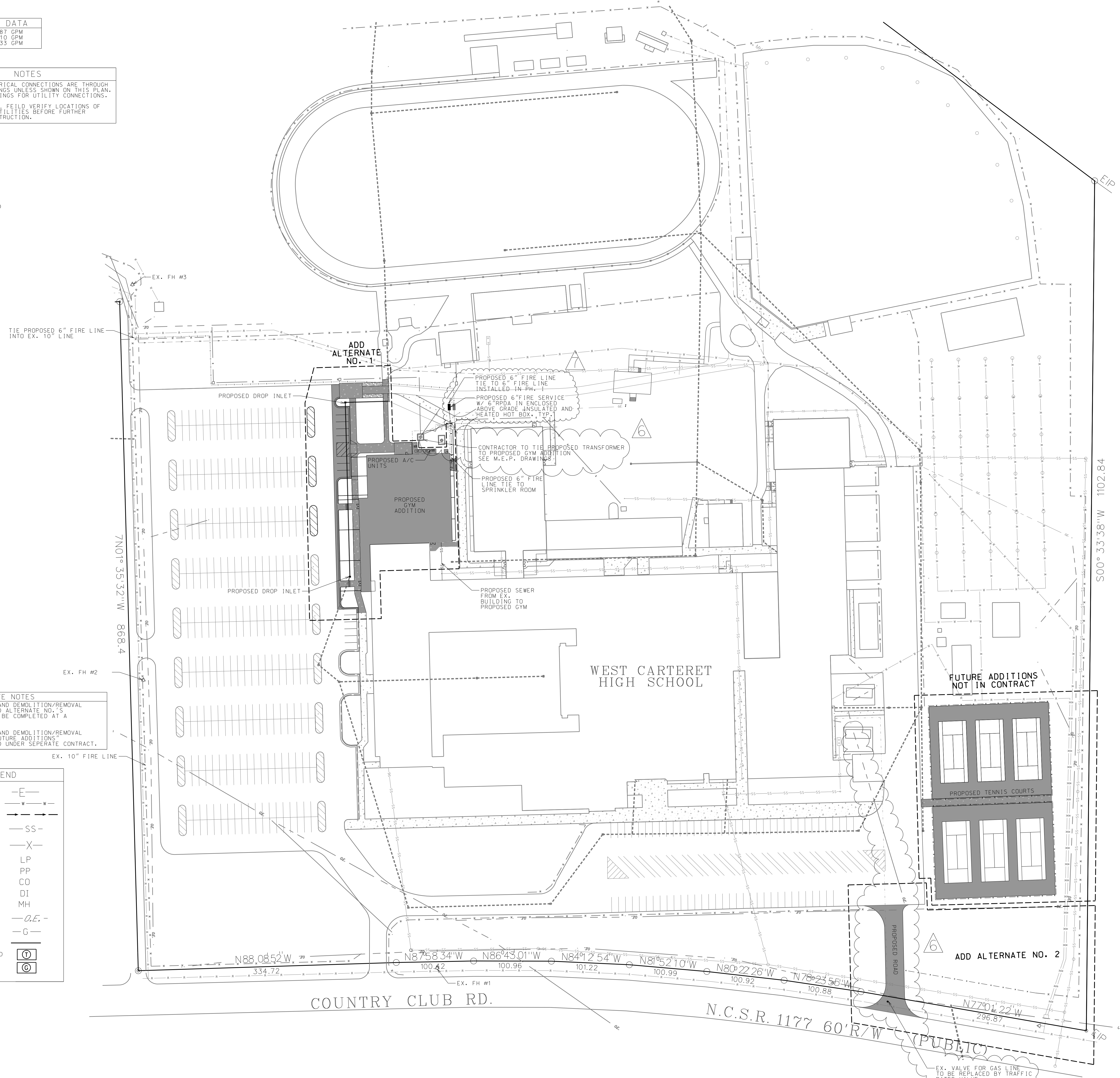

ADD ALTERNATE NOTES

ALL SITE WORK AND DEMOLITION/REMOVAL SHOWN UNDER ADD ALTERNATE NO. 1 AND 2 ARE TO BE COMPLETED AT A FUTURE DATE.

ALL SITE WORK AND DEMOLITION/REMOVAL SHOWN UNDER "FUTURE ADDITIONS" TO BE COMPLETED UNDER SEPARATE CONTRACT.

LEGEND

ELECTRIC LINE	—E—
WATER LINE	—W—W—
FORCE MAIN	—FW—FW—
SANITARY SEWER LINE	—SS—
CHAINLINK FENCE	—X—
LIGHT POLE	LP
POWER POLE	PP
CLEAN OUT	CO
DROP INLET	DI
SEWER MANHOLE	MH
OVERHEAD ELECTRIC	—O.E.—
GAS LINE	—G—
STORM DRAINAGE	—SD—
TRANSFORMER PAD	Ⓣ
GENERATOR PAD	ⓐ

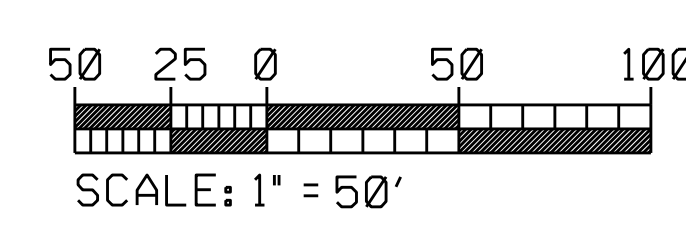

No.	Date	Revision
2	4/27/23	Fire Road Revisions
3	10/9/23	Add Alt Revisions
4	10/20/23	Revisions per Hite and Associates
5	11/02/23	Power Pole Revisions
6	11/14/23	ADDENDUM #2
7	12/1/23	REF14 - RRDAS W/ HOT BOXES

Hite associates
 ARCHITECTURE / PLANNING / TECHNOLOGY
 2600 Meridian Drive / Greenville, NC 27834 / tel: (252) 757-0333

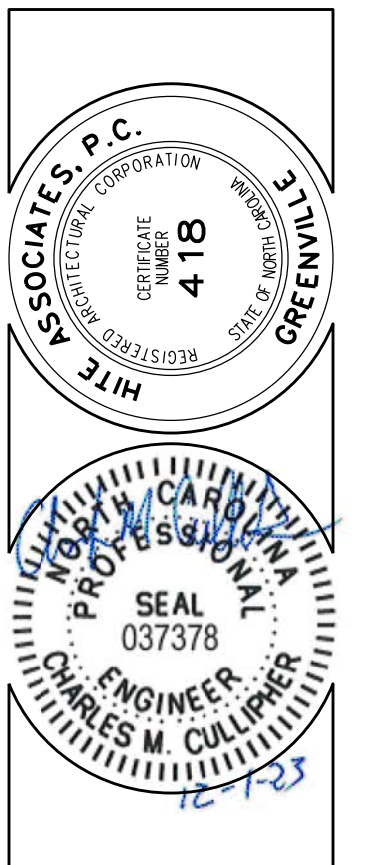

New Additions to WEST CARTERET HIGH SCHOOL
 4700 Country Club Road, Morehead City, NC 28557
 Carteret County Schools / North Carolina

Project No.	
Date:	9 June 2022
Drawing No.	C 701