

NOTE: CLEANOUT TO BE OF SAME MATERIAL AS PIPE U.O.N.

002.2 CLEAN OUT DETAIL

SCALE: NTS

ROOF PLAN NOTES:

- 1) THE GENERAL CONTRACTOR IS RESPONSIBLE FOR ALL VERTICAL ROOF DRAIN LEADERS AND HORIZONTAL DRAINAGE PIPING SYSTEMS TO STORM SEWER CATCH BASINS, PIPE AROUND STRUCTURE AS REQUIRED.
- 2) HORIZONTAL DRAINAGE PIPING BELOW GRADE SHALL BE SDR 35 PIPE, VERIFY ALL INVERT ELEVATIONS AND PIPE SLOPES PRIOR TO INSTALLATION.
- 3) PROVIDE CLEANOUTS AT ALL PIPING ELBOWS AT 80' INTERVALS FOR HORIZONTAL DRAINAGE PIPES 4" TO 6" NOMINAL DIAMETER AT 100' INTERVALS FOR HORIZONTAL DRAINAGE PIPES 8" AND ABOVE.
- 4) ICE AND WATER SHIELD TO BE INSTALLED UNDER ALL METAL ROOFING AS SPECIFIED
- 5) REFER TO PLUMBING AND MECHANICAL PLANS FOR ROOF PENETRATION LOCATIONS, GENERAL CONTRACTOR IS RESPONSIBLE FOR FLASHING ALL ROOF PENETRATIONS BY OTHER PRIME CONTRACTORS.
- 6) SANITARY SEWER HAS RIGHT-OF-WAY OVER STORM DRAINAGE PIPING; REFER TO PLUMBING DRAWINGS, CONSTRUCT CONCRETE MASONRY CONFLICT / JUNCTION BOX AS REQUIRED, SEE PLUMBING AND CIVIL DWGS.
- 7) COORDINATE CONDENSATE PIPING CONNECTIONS TO STORM DRAINAGE; REFER TO HVAC DRAWINGS.
- 8) GENERAL CONTRACTOR TO PRIME AND PAINT (2) COATS ALL VENTS, PIPES, AND FLUES EXTENDING THROUGH ROOF, MATCHING COLOR, CHEMICALLY CLEAN METAL AND PRIME GALVANIZED METAL WITH SPECIAL PRIMER AS SPECIFIED.
- 9) SLOPE ALL HORIZONTAL ROOF DRAINAGE LEADERS AS REQUIRED (1.0% SLOPE MIN)

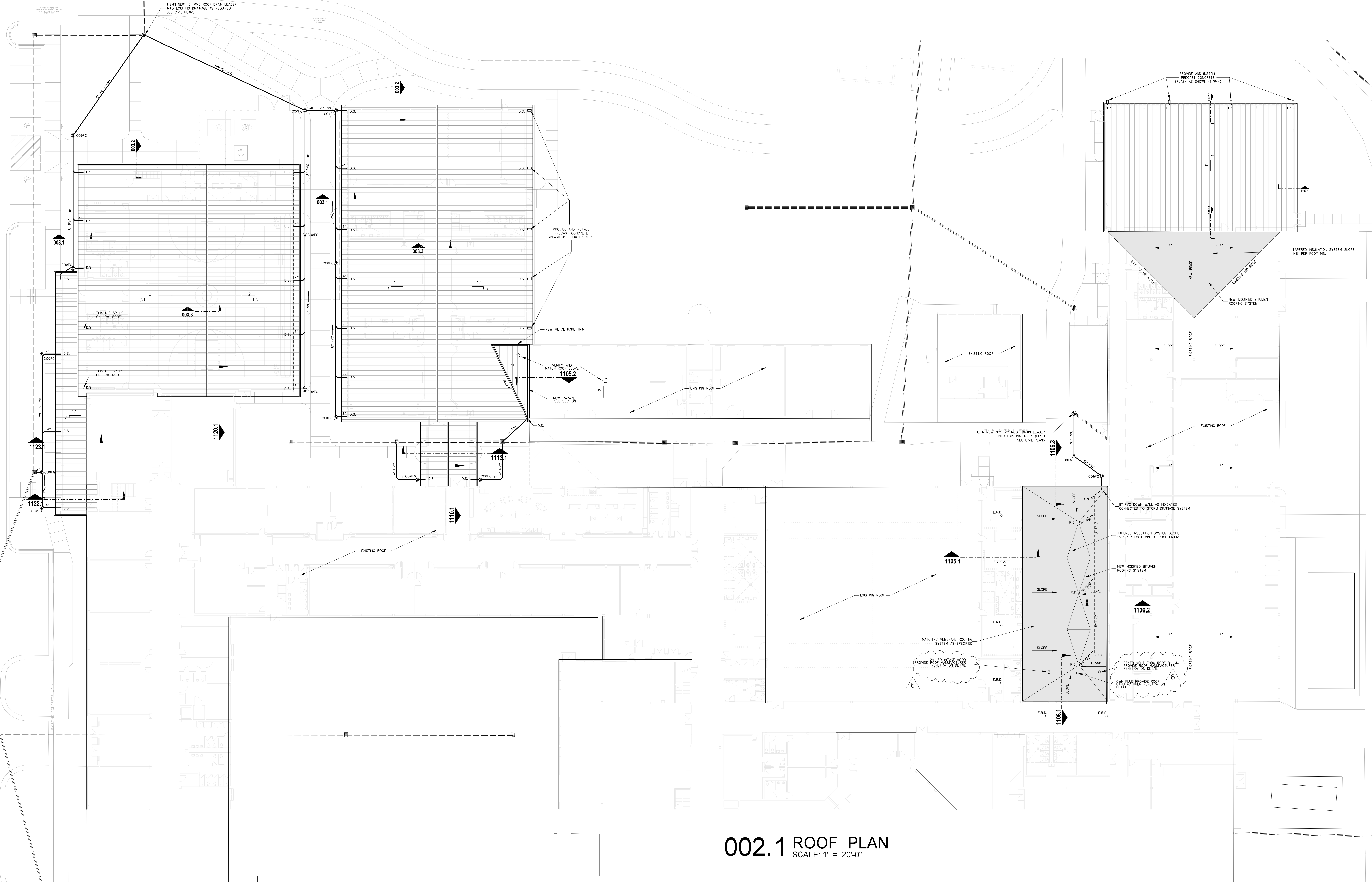

002.1 ROOF PLAN

SCALE: 1" = 20'-0"

No.	Date	Revision

Hite associates
 ARCHITECTURE / PLANNING / TECHNOLOGY
 2600 Meridian Drive / Greenville, NC 27834 / tel(252) 757-0333



New Gymnasium Additions to
West Carteret High School
 4700 Country Club Road, Morehead City, NC 28577
 Carteret County Schools / North Carolina

Project No.	22112
Date:	18 August 2022
Drawing no.	A 002