

**INTERIOR RENOVATION  
BASE BID  
THIS AREA**

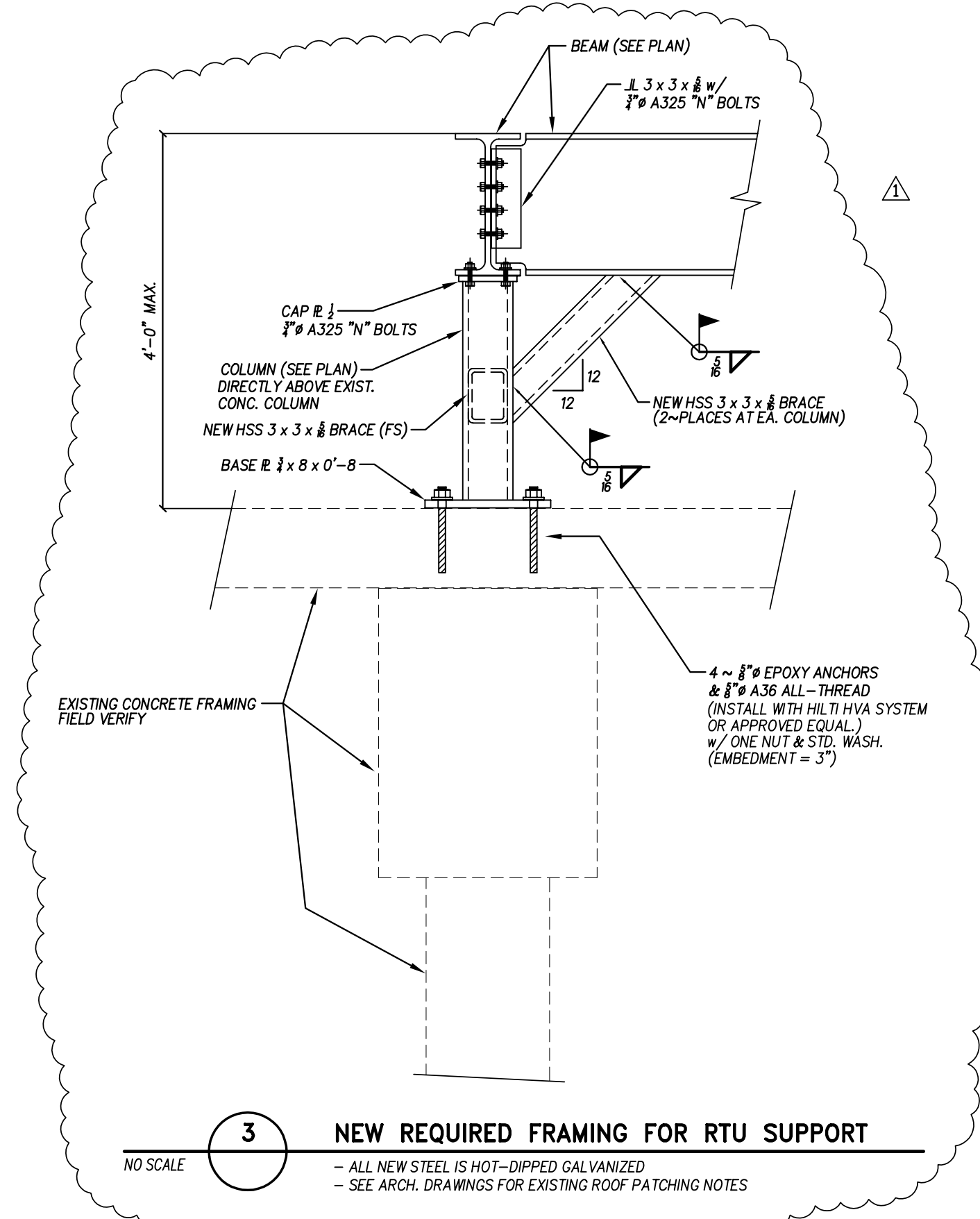

**3 NEW REQUIRED FRAMING FOR RTU SUPPORT**  
NO SCALE  
- ALL NEW STEEL IS HOT-DIPPED GALVANIZED  
- SEE ARCH. DRAWINGS FOR EXISTING ROOF PATCHING NOTES

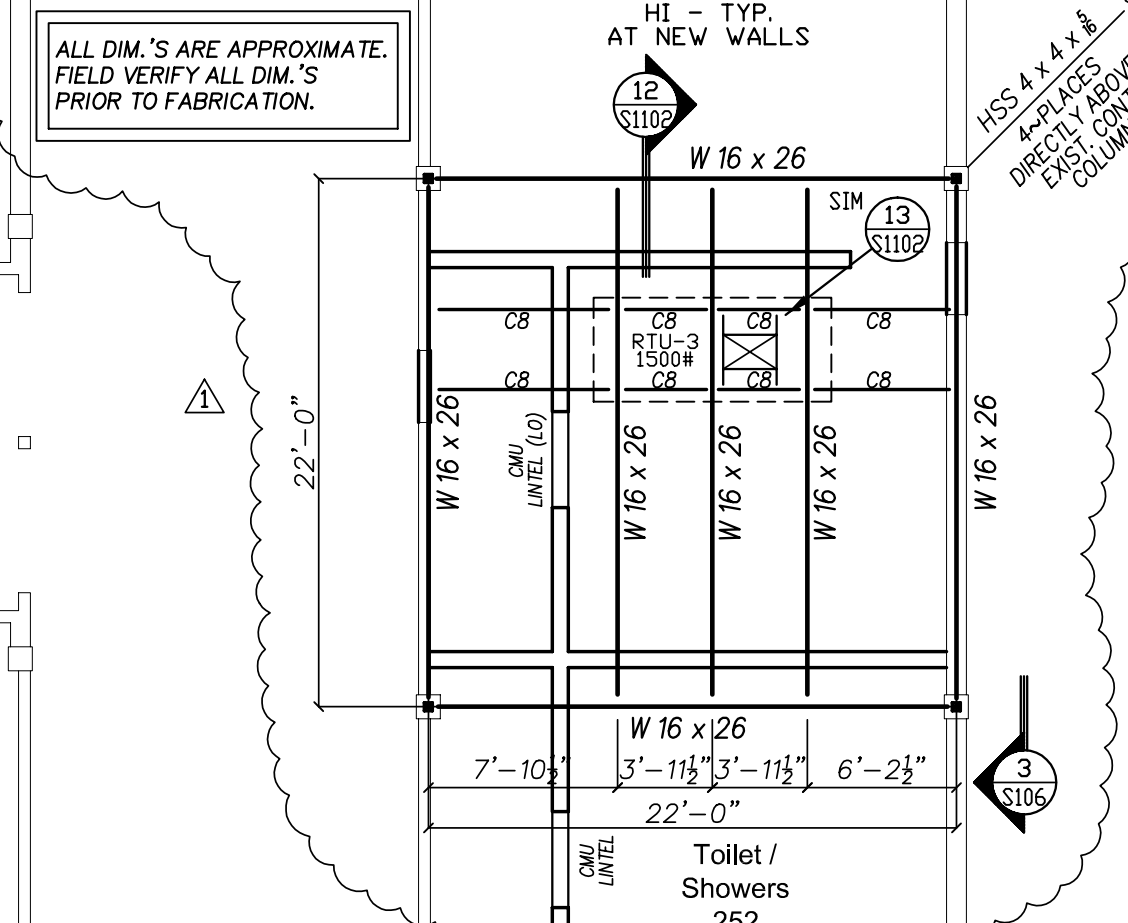
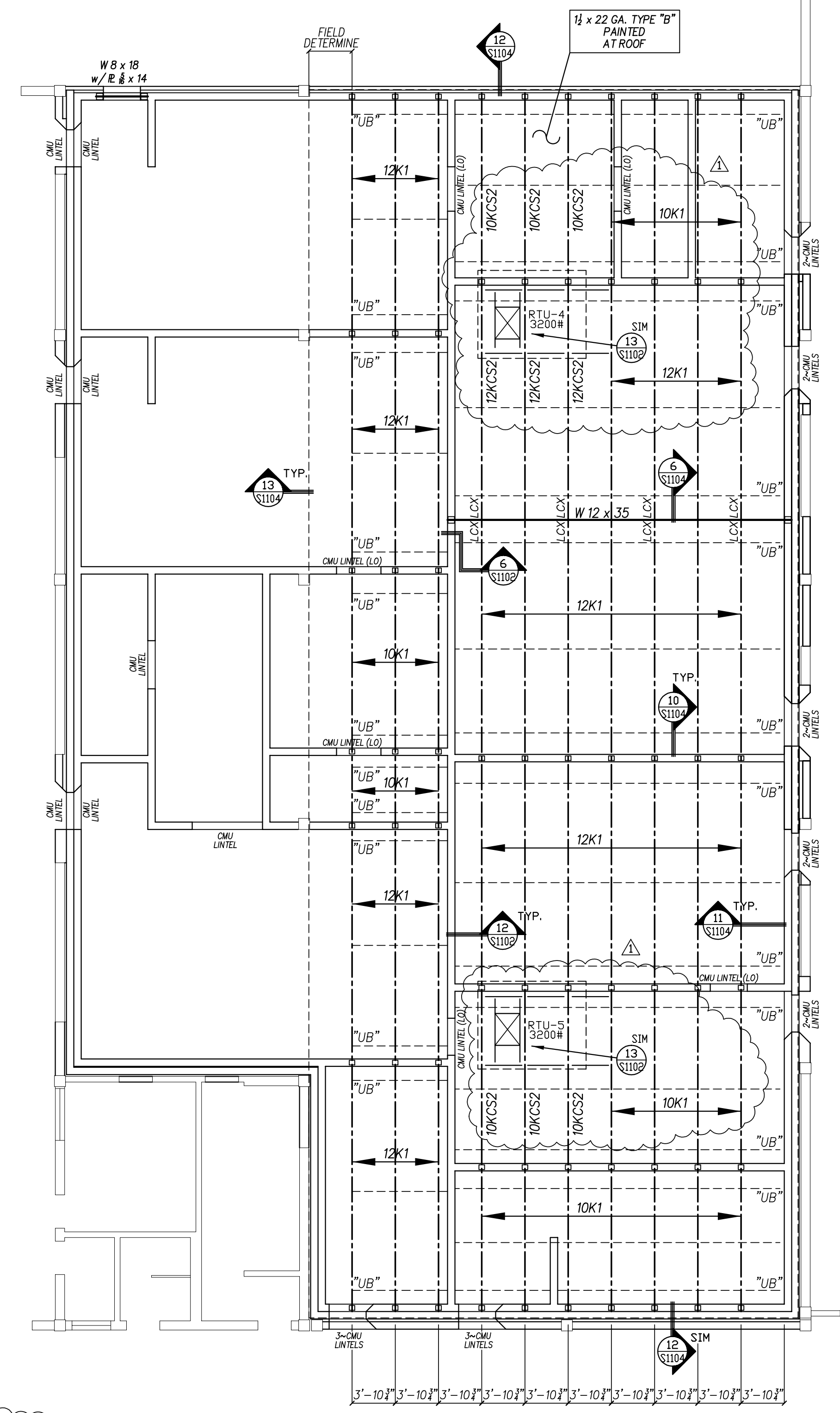

- NEW LINTEL IN EXISTING MASONRY WALL  
- FILL EXISTING MASONRY TO BEARING PER 6/S102  
- SEE ARCH. FOR ADDITIONAL NOTES THAT APPLY.  
- LINTEL B WIDTH SHALL BE 1" LESS THAN WALL WIDTH. FIELD VERIFY AS REQUIRED.

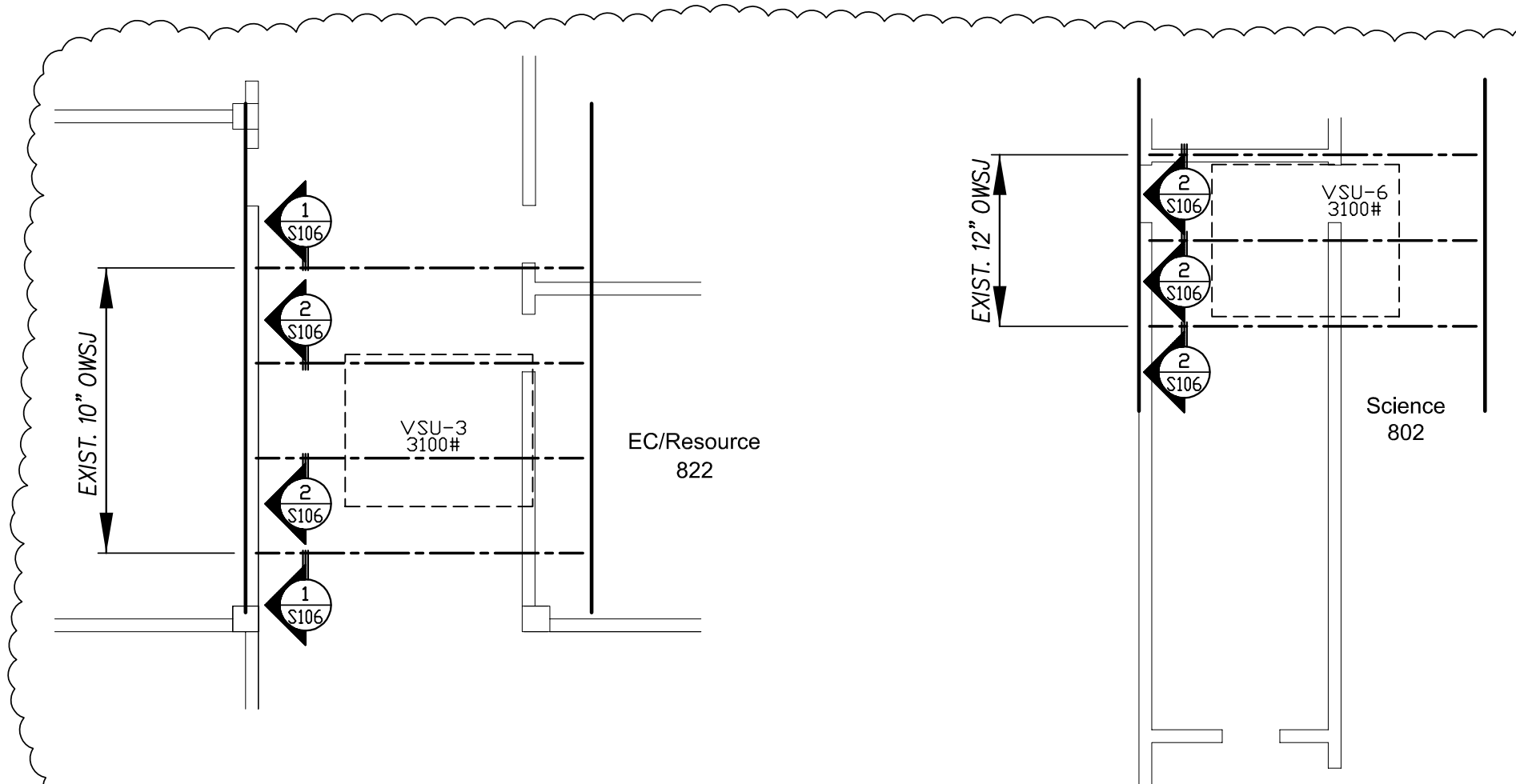

**BAR JOIST REINFORCING  
ROOF PART PLANS - BASE BID**

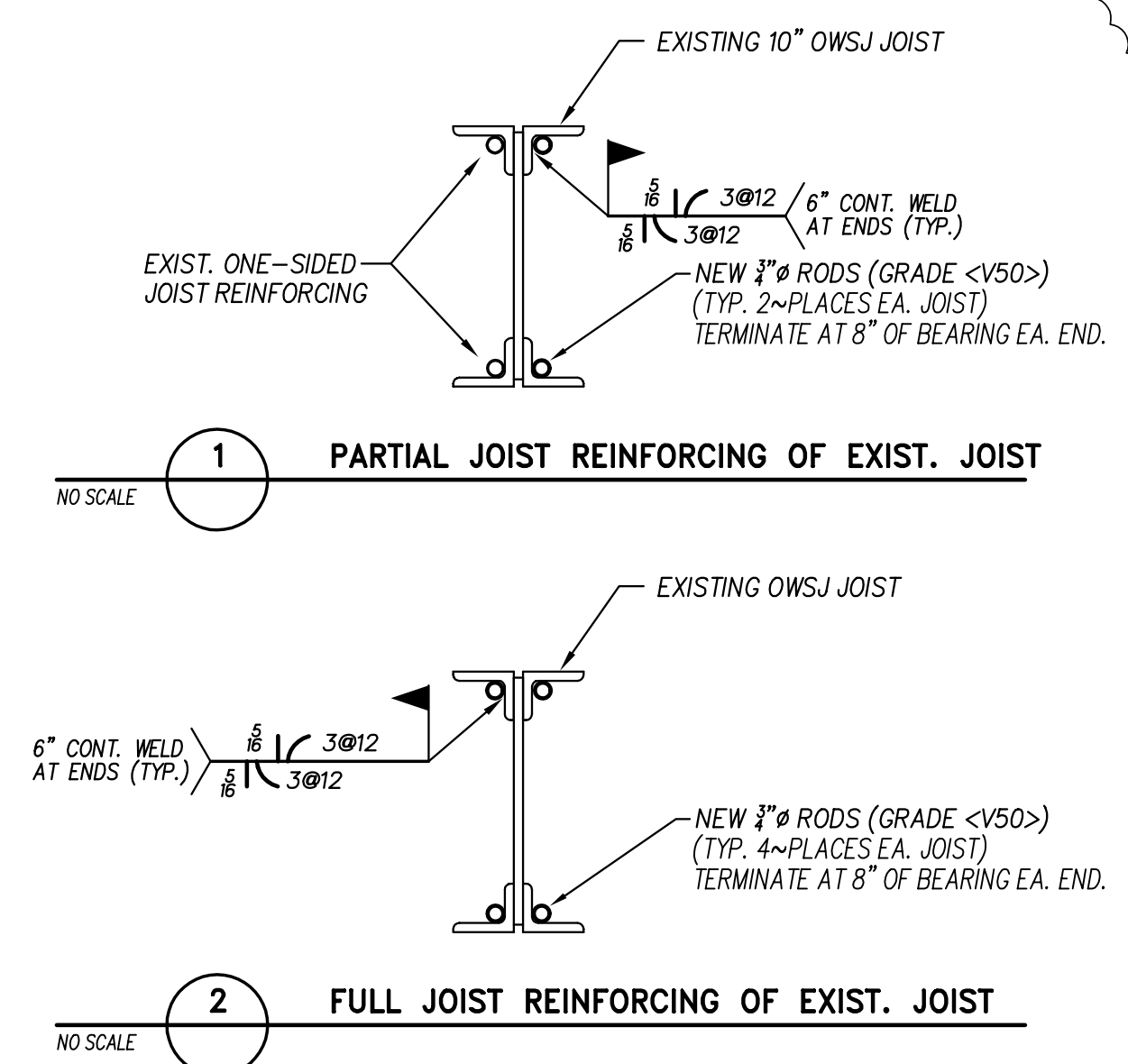

**1 PARTIAL JOIST REINFORCING OF EXIST. JOIST**  
NO SCALE

**2 FULL JOIST REINFORCING OF EXIST. JOIST**  
NO SCALE

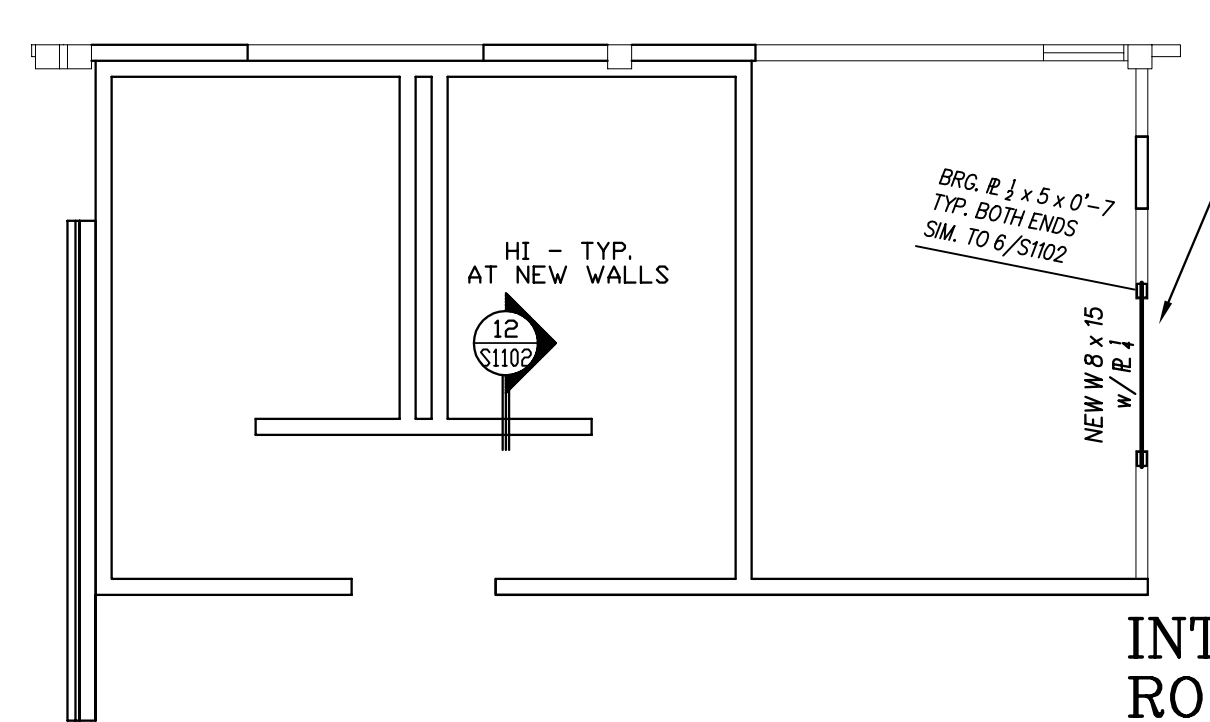

**INTERIOR RENOVATION  
ROOF PART PLAN - BASE BID**

- METAL ROOF DECK IS 1/2" x 22 GA TYPE "B" PAINTED M.R.D., TYP. U.G.N. FOR ATTACHMENT, SEE TYPICAL M.R.D. FASTENING DETAIL ON S102.
- ELEV NOTED(+ ) ARE ABOVE REFERENCED FINISHED FLOOR.
- METAL ROOF DECK IS TO BE USED TO TRANSMIT LATERAL LOADS TO WALLS. SEE TYP. DECK FASTENING PATTERN ON S102.
- JOIST SUPPLIER SHALL DESIGN JOISTS FOR ADDITIONAL POINT LOADS FROM ROOF TOP MECHANICAL UNITS (IF REQUIRED). CONTRACTOR SHALL VERIFY SIZE AND HEIGHT OF UNITS AND REPORT THIS INFORMATION TO THE STRUCTURAL ENGINEER OF RECORD, IF REQUIRED.
- ALL WIDE FLANGE BEAMS TO BE "A50" STEEL.
- SEE S1201 FOR NET UPLIFT DESIGN LOADING FOR ALL JOISTS AND GIRDERS.
- "UB" INDICATES UPLIFT BRIDGING TO BE LOCATED AT THE FIRST BOTTOM CHORD PANEL POINT OF JOIST.
- NO FABRICATION OR ERECTION SHALL COMMENCE PRIOR TO THE APPROVAL OF ALL STRUCTURAL STEEL SHOP DRAWINGS BY THE ENGINEER OF RECORD.
- JOIST MANUFACTURER SHALL ADJUST JOIST SEATS AS REQUIRED TO MAINTAIN DECK BEARING ELEVATIONS SHOWN ON THE CONTRACT DRAWINGS.
- COORDINATE AND VERIFY ALL DECK EDGE LOCATIONS AND DIMENSIONS WITH ARCHITECTURAL DRAWINGS.
- SEE 3/S103 AND 5/S103 FOR LCX CONFIGURATION.
- SEE 4/S103 FOR BCK CONFIGURATION.
- PROVIDE CONTINUOUS HORIZONTAL AND/OR DIAGONAL CROSS BRIDGING AT LOCATIONS SHOWN ON THE DRAWINGS. WHERE SJA STANDARDS REQUIRE ADDITIONAL LINES OF BRIDGING IN ADDITION TO THOSE SHOWN ON THE DRAWINGS THE ADDITIONAL LINES SHALL BE PROVIDED.
- LOCATE ALL WALLS AND MASONRY OPENINGS PER ARCHITECTURAL DRAWINGS.

No.	Date	Revision
1	11/27/23	REVISED PER PHASE REQUIREMENTS - ADD. #2

**Hite associates**  
ARCHITECTURE / ENGINEERING / TECHNOLOGY  
2600 Meridian Drive / Greenville, NC 27838 / tel (252) 757-0333

**QED**  
QUINN ENGINEERING & DESIGN  
ARCHITECTURE / ENGINEERING / TECHNOLOGY  
2600 Meridian Drive / Greenville, NC 27838 / tel (252) 757-0333

**Prince & Owen**  
ENGINEER  
BRUCE OWEN  
23 OCT 2023

New Additions to  
**West Carteret High School**  
4700 Country Club Road, Morehead City, NC 28577  
Carteret County Schools / North Carolina

Project No.	22112
Date:	23 OCT 2023
Drawing No.	S 106